

VDX120

Frame size	Stage	Ratio	※1	※2	※3	※4	※5	※6	※7
			Nominal output torque [Nm]	Maximum output torque [Nm]	Emergency stop torque [Nm]	Nominal input speed [rpm]	Maximum input speed [rpm]	Permitted radial load [N]	Permitted axial load [N]
VDX120	Single	3	120	225	500	3000	6000	1300	1500
		4	120	330	625	3000	6000	1500	1700
		5	180	330	625	3000	6000	1600	1900
		7	180	330	625	3000	6000	1800	2100
		10	120	225	500	3000	6000	2000	2500
	Double	15	120	225	500	3000	6000	2300	3000
		16	180	330	625	3000	6000	2300	3100
		20	180	330	625	3000	6000	2500	3400
		25	180	330	625	3000	6000	2700	3700
		28	180	330	625	3000	6000	2800	3900
		30	120	225	500	3000	6000	2900	3900
		35	180	330	625	3000	6000	3000	3900
		40	180	330	625	3000	6000	3200	3900
		50	180	330	625	3000	6000	3400	3900
		70	180	330	625	3000	6000	3800	3900
100	120	225	500	3000	6000	4300	3900		

Frame size	Stage	Ratio	※8	※9	Moment of inertia (≤Ø14) [kgcm ²]	Moment of inertia (≤Ø19) [kgcm ²]	Moment of inertia (≤Ø28) [kgcm ²]	Moment of inertia (≤Ø38) [kgcm ²]
			Maximum radial load [N]	Maximum axial load [N]				
VDX120	Single	3	4300	3900	—	3.10	5.0	12.0
		4	4300	3900	—	1.90	3.7	10.0
		5	4300	3900	—	1.40	3.1	9.5
		7	4300	3900	—	1.00	2.7	9.1
		10	4300	3900	—	0.82	2.5	8.8
	Double	15	4300	3900	0.76	1.10	2.9	—
		16	4300	3900	0.97	1.40	3.1	—
		20	4300	3900	0.72	1.10	2.8	—
		25	4300	3900	0.70	1.10	2.8	—
		28	4300	3900	0.92	1.30	3.0	—
		30	4300	3900	0.38	0.78	2.5	—
		35	4300	3900	0.68	1.10	2.8	—
		40	4300	3900	0.37	0.77	2.5	—
		50	4300	3900	0.36	0.76	2.5	—
		70	4300	3900	0.36	0.76	2.5	—
100	4300	3900	0.36	0.76	2.5	—		

Frame size	Stage	Ratio	※10						
			Precision backlash arcmin	Standard backlash arcmin	Efficiency(η) %	Weight [kg]	Temperature ℃	Service life hr	Protection level
VDX120	Single	3~10	≤ 3	≤ 5	≥ 95%	8.0	-10℃~+90℃	≥ 20000	IP65
	Double	15~100	≤ 5	≤ 7	≥ 92%	9.5			

- ※1 With nominal input speed, service life is 20,000 hours.
- ※2 The maximum torque when starting and stopping.
- ※3 The maximum torque when it receives shock. (up to 1,000 times)
- ※4 The maximum average input speed.
- ※5 The maximum momentary input speed.
- ※6 With this load and nominal input speed, service life will be 20,000 hours.
(Applied to the output shaft center, at axial load 0)
- ※7 With this load and nominal input speed, service life will be 20,000 hours.
(Applied to the output side bearing, at radial load 0)
- ※8 The maximum radial load the gearbox can accept.
- ※9 The maximum axial load the gearbox can accept.
- ※10 The weight may vary slightly model to model.

SAM GEARBOX

VDX 120 DRAWING

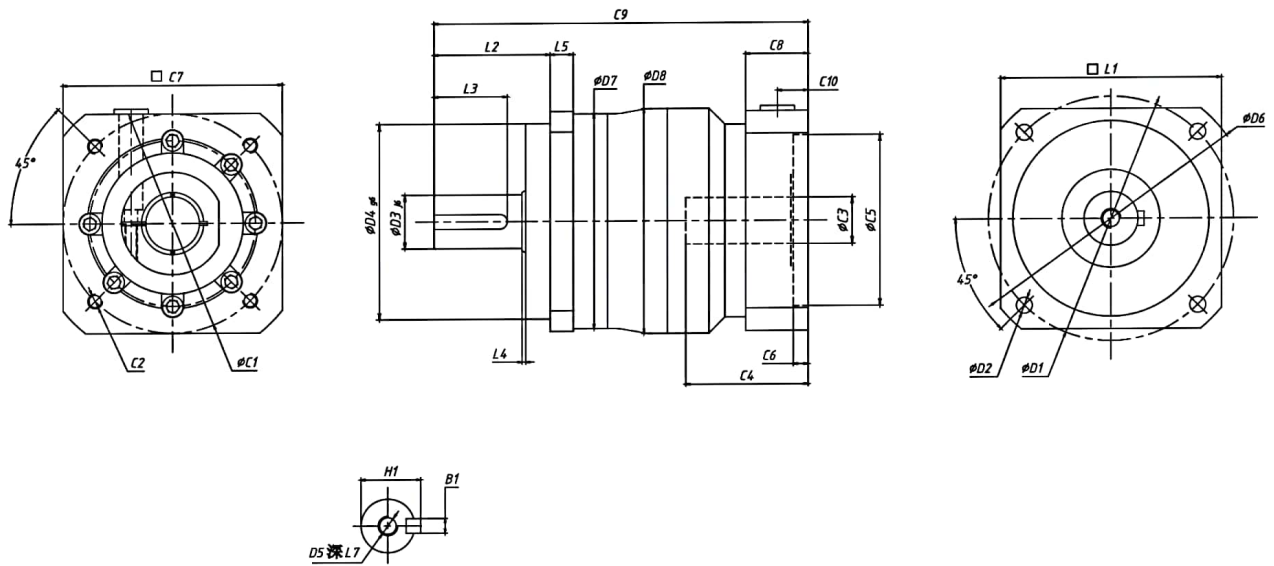

[unit:mm]

Dimension	AEP115
D1	130
D2	9
D3	32
D4	110
D5	M12 X 1.75P
D6	148
D7	113
D8	122
L1	115
L2	64.5
L3	50
L4	1.5
L5	10
C1 ¹	145
C2 ¹	M8 X 1.25P
C3 ¹	≤ 32
C4 ¹	58
C5 ¹	110
C6 ¹	8
C7 ¹	130
C8 ¹	40.5
C9 ¹	202
C10 ¹	28
B1	10
H1	35

※1 Length will vary depending on motor.

※2 Bushing will be inserted to adapt to motor shaft.